

# 010

---

**LAMPADINE, PRESSACAVI  
ED ACCESSORI**

**LAMPS, CABLE GLANDS AND  
ACCESSORIES**

# Lampadine Lamps

## BA9S Led luce fissa BA9S Steady light led lamps

g n cod

### 6V AC-DC

● Rosso / Red	2	5	010BA9SLR6
● Giallo / Yellow	2	5	010BA9SLG6
● Verde / Green	2	5	010BA9SLV6
● Blu / Blue	2	5	010BA9SLBL6
○ Bianco / White	2	5	010BA9SLB6

### 12V AC-DC

● Rosso / Red	2	5	010BA9SLR12
● Giallo / Yellow	2	5	010BA9SLG12
● Verde / Green	2	5	010BA9SLV12
● Blu / Blue	2	5	010BA9SLBL12
○ Bianco / White	2	5	010BA9SLB12

### 24V AC-DC

● Rosso / Red	2	5	010BA9SLR24
● Giallo / Yellow	2	5	010BA9SLG24
● Verde / Green	2	5	010BA9SLV24
● Blu / Blue	2	5	010BA9SLBL24
○ Bianco / White	2	5	010BA9SLB24

### 36V AC-DC

● Rosso / Red	2	5	010BA9SLR36
● Giallo / Yellow	2	5	010BA9SLG36
● Verde / Green	2	5	010BA9SLV36
● Blu / Blue	2	5	010BA9SLBL36
○ Bianco / White	2	5	010BA9SLB36

### 48V AC-DC

● Rosso / Red	2	5	010BA9SLR48
● Giallo / Yellow	2	5	010BA9SLG48
● Verde / Green	2	5	010BA9SLV48
● Blu / Blue	2	5	010BA9SLBL48
○ Bianco / White	2	5	010BA9SLB48

### 130V AC-DC

● Rosso / Red	2	5	010BA9SLR110
● Giallo / Yellow	2	5	010BA9SLG110
● Verde / Green	2	5	010BA9SLV110
● Blu / Blue	2	5	010BA9SLBL110
○ Bianco / White	2	5	010BA9SLB110

### 240V AC-DC

● Rosso / Red	2	5	010BA9SLR240
● Giallo / Yellow	2	5	010BA9SLG240
● Verde / Green	2	5	010BA9SLV240
● Blu / Blue	2	5	010BA9SLBL240
○ Bianco / White	2	5	010BA9SLB240

### 400V AC-DC

● Rosso / Red	2	5	010BA9SLR400
● Giallo / Yellow	2	5	010BA9SLG400
● Verde / Green	2	5	010BA9SLV400
● Blu / Blue	2	5	010BA9SLBL400
○ Bianco / White	2	5	010BA9SLB400

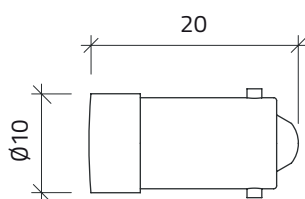

# Lampadine

## Lamps

### BA9S Led luce fissa BA9S Steady light led lamps

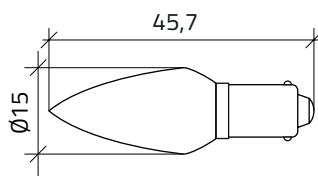

#### 24V AC-DC

	g	cod
● Rosso / Red	2	010BA9ALR24
● Giallo / Yellow	2	010BA9ALG24
● Verde / Green	2	010BA9ALV24
● Blu / Blue	2	010BA9ALBL24
○ Bianco / White	2	010BA9ALB24

#### 240V AC-DC

● Rosso / Red	2	010BA9ALR220
● Giallo / Yellow	2	010BA9ALG220
● Verde / Green	2	010BA9ALV220
● Blu / Blue	2	010BA9ALBL220
○ Bianco / White	2	010BA9ALB220

### Led <60V non polarizzati 110-240 V polarizzati Led lamps <60V non-polarized 110-240 V polarized

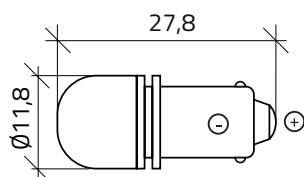

#### Led luce lampeggiante / Flashing light led

Led ultraluminoso tensioni  $\pm 15\%$  non polarizzata / Ultra-bright led, voltage  $\pm 15\%$  non-polarized  
AC-DC 6 12 24 48 110 AC 220 mA 30 20 14 7 5 16

#### 24V AC-DC

● Rosso / Red	2	010BA9SLLR24
---------------	---	--------------

#### 130V AC-DC

● Rosso / Red	2	010BA9SLLR110
---------------	---	---------------

#### 240V AC-DC

● Rosso / Red	2	010BA9SLLR220
---------------	---	---------------

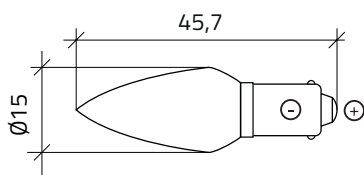

#### 24V AC-DC

● Rosso / Red	2	010BA9ALLR24
---------------	---	--------------

### Nuove lampade due colori , tecnologia led alta luminosità New bi-colour led lamps,high brightness

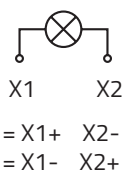

#### 24V DC 15mA

1 2		
● ● Verde, rosso / Green, red	2	010BA9SLVR24
● ● Verde, giallo / Green, yellow	2	010BA9SLVG24
● ● Blu, rosso / Blue, red	2	010BA9SLBLR24
● ● Blu, giallo / Blue, yellow	2	010BA9SLBLG24

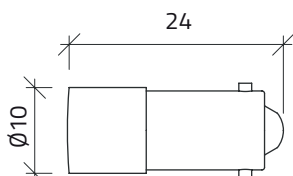

# Lampadine Lamps

## BA9S Lampadine ad incandescenza BA9S Incandescent lamps

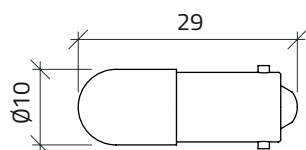

			g	n	cod
6V	0,6W	1,3	10		<b>010BA9S6V-0.6W</b>
24V	1,2 W	1,3	10		<b>010BA9S24V-1.2W</b>
24V	3W	1,3	10		<b>010BA9S24V-3W</b>
30V	1,2W	1,3	10		<b>010BA9S30V-1.2W</b>
30V	3W	1,3	10		<b>010BA9S30V-3W</b>
48V	1,2W	1,3	10		<b>010BA9S48V-1.2W</b>
60V	1,2 W	1,3	10		<b>010BA9S60V-1.2W</b>
60V	3W	1,3	10		<b>010BA9S60V-3W</b>
110V	1,9W	1,3	10		<b>010BA9S130V-1.9</b>
220V	2W	1,3	10		<b>010BA9S220V-2W</b>

## BA9S Lampadine al neon / BA9S neon lamps

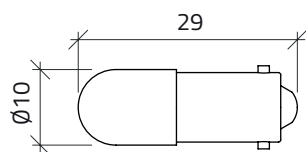

			g	n	cod
<b>Neon AC</b>					
● Arancio / Orange	65V	0,05W	2,3	10	<b>010BA9SN65</b>
● Arancio / Orange	130V	0,1W	2,3	10	<b>010BA9SN110</b>
● Verde / Green	130V	0,1W	2,3	10	<b>010BA9NV110</b>
● Arancio / Orange	240V	0,3W	2,3	10	<b>010BA9SN220</b>
● Verde / Green	240V	0,3W	2,3	10	<b>010BA9NV220</b>
● Arancio / Orange	400V	0,5W	2,3	10	<b>010BA9SN380</b>
● Verde / Green	400V	0,5W	2,3	10	<b>010BA9NV380</b>

## BA15D Lampadine led / BA15D led lamps

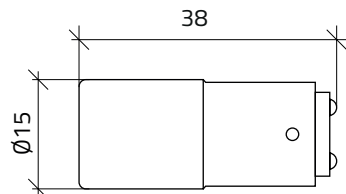

		g	cod
<b>24V AC-DC</b>			
○ Bianco / White		2	<b>010BA15DLB24</b>
<b>230V AC-DC</b>			
○ Bianco / White		2	<b>010BA15DLB220</b>

# Chiavi Keys

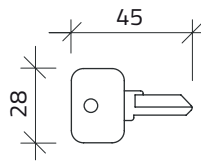
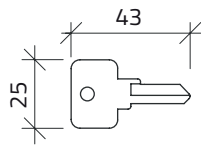

## Chiavi / Keys

	g	c	n	cod
	11	3095	2	<b>010K95</b>
	11	3353	2	<b>010K53</b>
	11	9901	2	<b>010K01</b>
	11	9902	2	<b>010K02</b>
	11	9903	2	<b>010K03</b>
	11	9904	2	<b>010K04</b>
	11	9905	2	<b>010K05</b>
	11	9910	2	<b>010K10</b>
	11	9916	2	<b>010K16</b>
	11	9919	2	<b>010K19</b>

Versione secondo normativa FIAT / Version according to FIAT standards

● Nero / Black	11	73034	2	<b>010K34</b>
● Rosso / Red	11	73037	2	<b>010K37</b>
● Giallo / Yellow	11	73033	2	<b>010K33</b>
● Blu / Blue	11	73038	2	<b>010K38</b>
● Arancio / Orange	11	73040	2	<b>010K40</b>

# Pressacavi in termoplastico

## Thermoplastic cable glands

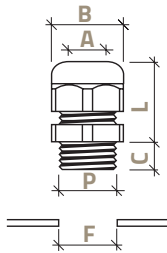

### Pressacavi / Cable glands



Poliammide PA6 autoestinguente cl. V2 (UL94) - Temperatura di impiego -20°/+90°  
 V2 (UL94) self-extinguishing PA6 polyamide - Operating temperature -20°/+90°

● Nero / Black	M12 x 1,5	4	12,5	3-6,5	15	8	25	<b>010NM12</b>
● Nero / Black	M16 x 1,5	7	16,5	5-10	22	10	32	<b>010NM16</b>
● Nero / Black	M20 x 1,5	11	20,5	6-12	24	10	32	<b>010NM20</b>
● Nero / Black	M20 x 1,5	11	20,5	10-14	27	10	32	<b>010NM20A</b>
● Nero / Black	M25 x 1,5	16	25,5	13-18	33	10	38	<b>010NM25</b>
● Nero / Black	M32 x 1,5	23	32,5	18-25	42	15	43	<b>010NM32</b>
● Nero / Black	PG7	4	12,5	3-6,5	15	8	25	<b>010NPG7</b>
● Nero / Black	PG9	6	15,5	4-8	19	8	27	<b>010NPG9</b>
● Nero / Black	PG11	9	19	5-10	22	8	32	<b>010NPG11</b>
● Nero / Black	PG11	9	19	4-7	22	8	32	<b>010NPG11R</b>
● Nero / Black	PG13,5	11	20,5	6-12	24	10	32	<b>010NPG13</b>
● Nero / Black	PG16	13	22,5	10-14	27	10	32	<b>010NPG16</b>
● Nero / Black	PG21	21	29	13-18	33	12	38	<b>010NPG21</b>
○ Bianco / White	PG29	27	38	18-25	42	11	35-40	<b>010NPG29</b>

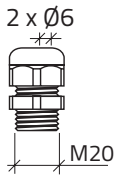

### Pressacavo 2 ingressi / 2-hole cable gland



10 **0102P20**

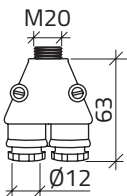

### Pressacavo 2 vie / Double entry cable gland

45 **010N2M20**

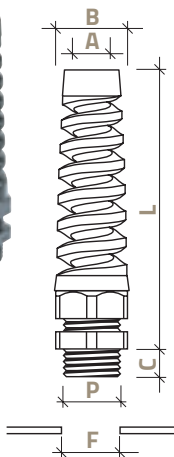

### Pressacavi con spirale / Spiral cable glands

Poliammide PA6 autoestinguente cl. V2 (UL94) - Temperatura di impiego -20°/+90°  
 V2 (UL94) self-extinguishing PA6 polyamide - Operating temperature -20°/+90°

M12 x 1,5	7	12,5	3-6,5	15	8	58	<b>010FM12</b>
M16 x 1,5	10	16,5	5-10	22	10	83	<b>010FM16</b>
M20 x 1,5	19	20,5	6-12	24	10	96	<b>010FM20</b>
M20 x 1,5	19	20,5	10-14	27	10	96	<b>010FM20A</b>
M25 x 1,5	33	25,5	13-18	33	10	119	<b>010FM25</b>
PG11	16	19	5-10	22	8	83	<b>010FPG11</b>
PG13,5	19	20,5	6-12	24	10	96	<b>010FPG13</b>
PG16	25	22,5	10-14	27	10	106	<b>010FPG16</b>
PG21	25	29	13-18	33	11	119	<b>010FPG21</b>

# Tappi, riduzioni e controdadi in termoplastico

## Thermoplastic hole plugs, reducers and locknuts

### Tappi di chiusura / Hole plugs

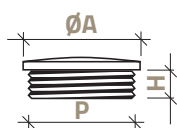

P — ØA — H — g — cod

Polistirene PS - Temperatura di impiego -20°/+60°  
PS Polystyrene - Operating temperature -20°/+60°

	P	ØA	H	g	cod
M12 x 1,5	15		10	1	010TM12
M16 x 1,5	19,5		10	2	010TM16
M20 x 1,5	25		10	2,4	010TM20
M25 x 1,5	30		10	4	010TM25
M32 x 1,5	37		10	4,2	010TM32
PG7	15		10	1	010TPG7
PG9	19,5		10	1,5	010TPG9
PG11	22		10	2	010TPG11
PG13,5	25		10	2	010TPG13
PG16	27		10	3	010TPG16
PG21	33		10	4	010TPG21

### Riduzioni in plastica / Plastic reducers

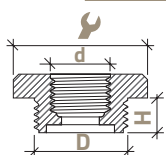

D — d — H —  — g — cod

D	d	H		g	cod
M25	M12	10	29	8	010RM25M12

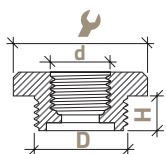

M25	M16	10	32	9	010RM25M16
-----	-----	----	----	---	------------

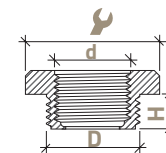

M25	M20	10	32	7,8	010RM25M20
-----	-----	----	----	-----	------------

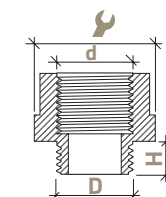

M20	M25	10	32	6,8	010RM20M25
-----	-----	----	----	-----	------------

### Controdadi / Locknuts

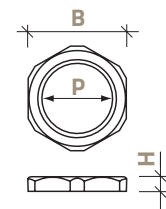

P — B — H — g — n — cod

Poliammide PA6 autoestinguente cl. V2 (UL94) - Temperatura di impiego -20°/+90°  
V2 (UL94) self-extinguishing PA6 polyamide - Operating temperature -20°/+90°

● Nero / Black	M12 x 1,5	18	5	1	10	010DM12
● Nero / Black	M16 x 1,5	24	6	1,5		010DM16
● Nero / Black	M20 x 1,5	27	6	2		010DM20
● Nero / Black	M25 x 1,5	34	7	3		010DM25
● Nero / Black	M32 x 1,5	41	7	4		010DM32
● Nero / Black	PG7	19	5	1		010DPG7
● Nero / Black	PG9	22	5	2		010DPG9
● Nero / Black	PG11	24	5	2		010DPG11
● Nero / Black	PG13,5	27	6	2,5		010DPG13
● Nero / Black	PG16	30	6	3		010DPG16
● Nero / Black	PG21	36	7	3,5		010DPG21
○ Bianco / White	PG29	46	7,5	5		010DPG29

# Valvole di ventilazione anticondensa

## Ventilation plugs ( to prevent condensation)

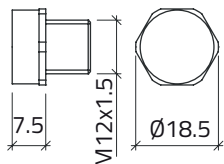

Permeabilità all'aria / Air permeability 2lt./min. $\Delta p = 70$ mbar  
 Pressione ingresso acqua / Water inlet pressure max 0,2 bar / 60 s

● Nero / Black

1,5

10

**010VV**

g n cod

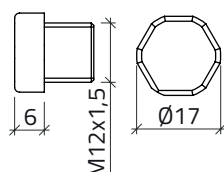

Permeabilità all'aria / Air permeability 0,4it./min. $\Delta p = 70$ mbar  
 Pressione ingresso acqua / Water inlet pressure max 0,6 bar / 60 s

● Grigio / Grey

1,5

**010VV400**

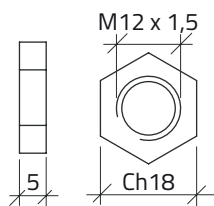

● Nero / Black

0,7

10

**010DM12**

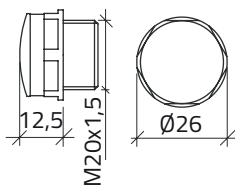

Permeabilità all'aria / Permeability to air 12,5lt./min. $\Delta p = 70$ mbar  
 Pressione ingresso acqua / Water inlet pressure max 0,1 bar / 60 s

● Nero / Black

6,0

**010VV12500**

g cod

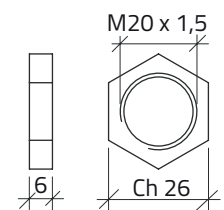

● Nero / Black

2

**010DM20**

# Cavo USB

## USB cable



Cavo mt 0,8  
Cable mt 0,8

**Tipo M-M (maschio-maschio)**  
**Type M-M (male-male)**

● Nero / Black

g

37

cod

**010CUSBMM8**



Cavo mt 2  
Cable mt 2

**Tipo M-M (maschio-maschio)**  
**Type M-M (male-male)**

● Nero / Black

g

77



cod

**010CUSBMM20**

# Pressacavi e riduzioni in metallo OTTONE NICHELATO

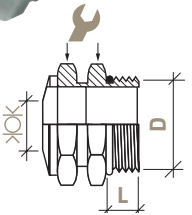
## Metal cable glands and adapters NICKEL-PLATED BRASS







g	D			L	cod
14	M16x1,5	5 ÷ 9	18	17	<b>010POM16</b>
20	M20x1,5	8 ÷ 12	22	22	<b>010POM20</b>
34	M25x1,5	11 ÷ 16	28	28	<b>010POM25</b>
50	M32x1,5	15 ÷ 21	35	35	<b>010POM32</b>

### Pressacavi / Cable glands

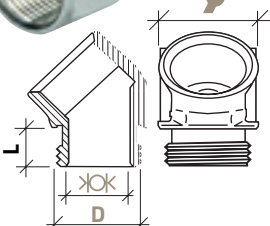
14	M16x1,5	5 ÷ 9	18	17	<b>010POM16</b>
20	M20x1,5	8 ÷ 12	22	22	<b>010POM20</b>
34	M25x1,5	11 ÷ 16	28	28	<b>010POM25</b>
50	M32x1,5	15 ÷ 21	35	35	<b>010POM32</b>

### Raccordo a gomito 45° / Elbow fittings to 45°





g	D			L	cod
26	M16x1,5	11,5	19	10	<b>010GIM16</b>
38	M20x1,5	15	23	10	<b>010GIM20</b>
55	M25x1,5	20	28	10	<b>010GIM25</b>
90	M32x1,5	27	36	10	<b>010GIM32</b>

26	M16x1,5	11,5	19	10	<b>010GIM16</b>
38	M20x1,5	15	23	10	<b>010GIM20</b>
55	M25x1,5	20	28	10	<b>010GIM25</b>
90	M32x1,5	27	36	10	<b>010GIM32</b>

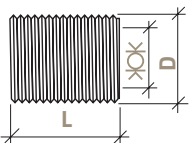

### Nippli / Nipples

g	D		L	cod
8	M16x1,5	12	21	<b>010NPM16</b>
20	M20x1,5	15	24,5	<b>010NPM20</b>
18	M25x1,5	20	25	<b>010NPM25</b>
30	M32x1,5	26	32	<b>010NPM32</b>

### Riduzioni / Adapters

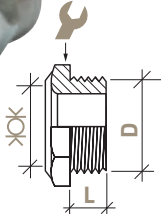
g	D			L	cod
18	M16x1,5	12	22	12	<b>010BM16</b>
22	M20x1,5	15	26	14	<b>010BM20</b>
20	M25x1,5	21	30	14	<b>010BM25</b>
28	M32x1,5	28	40	15	<b>010BM32</b>





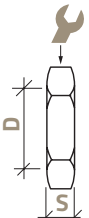

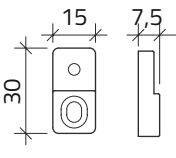

### Controdadi / Locknuts

g	D		S	cod
4	M16x1,5	19	3	<b>010GM16</b>
6	M20x1,5	24	3,5	<b>010GM20</b>
12	M25x1,5	30	3,5	<b>010GM25</b>
26	M32x1,5	36	4,5	<b>010GM32</b>

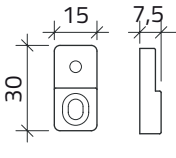
# Accessori per scatole pulsantiere

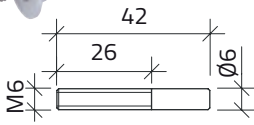
## Accessories for push-button enclosures

		L	g	cod
				
	<b>Kit di staffe di fissaggio 10 mm</b> Set of mounting brackets 10 mm		28	010S10
				
	<b>Kit di staffe di fissaggio 25mm</b> Set of mounting brackets 25 mm		32	010S25
				
	<b>Kit di fissaggio con prigionieri (M4/M10)</b> Fixing kit with (M4/M10) studs		26	010SFP
				
	<b>Guida / PVC Rail Ø 35</b>	2000	760	010GDP
				
	<b>Cinghia tracolla / Shoulder belt</b> 25X1400 mm		46	010CT25
				
	<b>Morsettiera 12 poli</b> Terminal block 12 poles		86	010M12

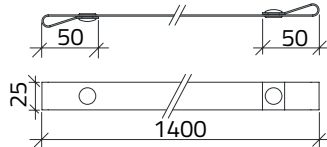
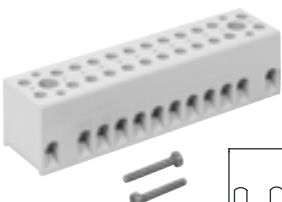
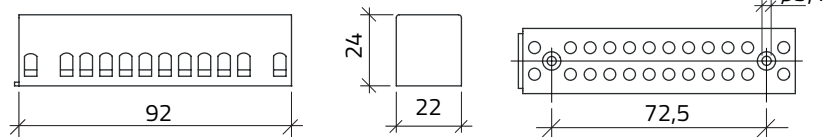

**ELFIN**  
TORINO - ITALY  
016 P3P xx  
PATENTED

**ELFIN**  
TORINO - ITALY  
016 P3P xx  
PATENTED

**ELFIN**  
TORINO - ITALY  
016 P3P xx  
PATENTED

**ELFIN**  
TORINO - ITALY  
016 P3P xx  
PATENTED

# 016

---

**PULSANTI DI ABILITAZIONE  
ED ACCESSORI**

**ENABLING SWITCHES  
AND ACCESSORIES**

# Pulsanti di abilitazione a 3 posizioni Ø16

## 3-position enabling switches Ø16

**I** Il pulsante di abilitazione a 3 posizioni antipanico é un comando manuale utilizzato nelle aree di pericolo dei sistemi di automazione industriale. Questo dispositivo supplementare è usato in combinazione con un comando di avviamento che, solo se attivato ed in modo mantenuto, consente alla macchina di funzionare.

**T** The 3-position enabling device is a manual control used in the tool machine danger zone in industrial automatic systems. This supplementary device is used in conjunction with a start control which, only when activated and maintained in the active position, it enables the operation of the machine.

Il pulsante di abilitazione può essere usato per la messa a punto, l'apprendimento, il cambio di lavorazione, la ricerca guasti, la pulizia e/o manutenzione della macchina, ovvero dove è necessario spostare o rimuovere le protezioni o escludere i dispositivi di sicurezza tradizionali. Per effettuare queste operazioni è necessario che la macchina possa essere avviata anche in situazioni pericolose mantenendo la sicurezza dell'operatore al livello più alto possibile. Azionando il dispositivo di comando solo in una determinata posizione vengono autorizzati i funzionamenti dei meccanismi potenzialmente pericolosi. Per mantenere controllata e sicura tutta l'azione è necessario che tutto l'apparecchio sia controllato in condizioni di rindondanza con un relè di sicurezza a doppia catena ad un arresto in categoria 0 o 1.

Nel montaggio evitare qualsiasi pressione nella parte centrale in modo da non bloccare il meccanismo

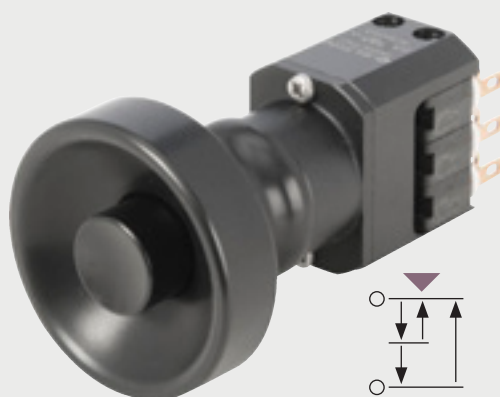

The engagement button can be used for tuning, training, changing the working process, searching for faults, cleaning and maintaining the machine, and in all cases where it is necessary to move or remove safety guards or disconnected traditional safety devices.

To carry out these operations it must be possible to start up the machine in dangerous situations, maintaining safe working conditions at the highest possible level. By activating the control in a specific position, potentially dangerous mechanisms can be activated. To ensure that the whole action is safe and under control, the equipment must be checked while idle with a double chain safety relay with stoppage in category 0 or 1.

During assembly avoid placing pressure on the central point as this could block the mechanism.

Il pulsante di abilitazione può essere fornito fino ad una combinazione di quattro contatti NO+NC a camere separate permettendo così di controllare in retroazione l'efficienza dei vari elementi.

- **posizione 1:** interruttore in funzione di messa fuori tensione (attuatore non attivato)
- **posizione 2:** funzione di consenso (attuatore attivato nella sua posizione intermedia)
- **posizione 3:** interruttore in funzione di messa fuori tensione (attuatore attivato al di là della posizione intermedia)

Quando si torna alla posizione 1 dalla posizione 3 il funzionamento non deve essere consentito. La NEW ELFIN fornisce questo dispositivo di abilitazione con estrema attenzione ai principi ergonomici; la dimensione miniaturizzata permette l'installazione in diverse complesse applicazioni. Le distanze di posizione e il differenziale d'intervento danno un funzionamento certo ed intuitivo.

The enabling device can be supplied in a combination of up to four NO+NC components in separate chambers, thus enabling retroactive check of the efficiency of the various elements.

- **position 1:** off (actuator not engaged)
- **position 2:** enabled (actuator engaged in the intermediate position)
- **position 3:** off (actuator engaged beyond the intermediate position)

When returning to position 1 from position 3, operation must not be allowed.

NEW ELFIN supplies this enabling device paying extreme attention to ergonomic principles; its small size enables installation in various complex applications. The positioning distances and operating differential make operation sure and intuitive.

# Pulsanti di abilitazione a 3 posizioni Ø16

## 3-position enabling switches Ø16

### Caratteristiche tecniche

Rispondenza alle norme	IEC EN 60947-5-8 / CEI EN 60204-1 CEI EN 11161 / UNI 10218-1
Temperatura tollerata	Temperatura di funzionamento -30 °C / + 70 °C
Grado di protezione	IP40 / IP66 con cappuccio in gomma
Forze di azionamento	Posizione 1 > 2 : 10n, posizione 2 > 3 : 25n
Durata meccanica	3 x 10 <sup>5</sup> operazioni UNI EN ISO 1349-1 B10d = 100.000 Operazioni
Microinterruttori	Commutazione contatti a scatto rapido a doppia rottura Vn: 250V ac/dc max In: 5A max Ith: 10A Ui: 300V Durata elettrica: 2x10 <sup>4</sup> cicli di manovre (250v-5A-cosφ 0,8) Terminali: faston clip 2,8 x 0,5 - T7 a saldare
Omologazioni	UL - CSA (switch)

### Technical data

Compliance to standards	IEC EN 60947-5-8 / CEI EN 60204-1 CEI EN 11161 / UNI 10218-1
Tolerated temperature	Working temperatures -30 °C / + 70 °C
Degree of protection	IP40 / IP66 with rubber cap
Actuating forces	Position 1 > 2 : 10n, position 2 > 3 : 25n
Mechanical durability	3 x 10 <sup>5</sup> operations UNI EN ISO 1349-1 B10d = 100.000 operations
Microswitches	Snap action double break switch Vn: 250V ac/dc max In: 5A max Ith: 10A Ui: 300V Electrical durability: 2x10 <sup>4</sup> operations (250v-5A-cosφ 0,8) Terminals: faston clip 2,8 x 0,5 - T7 solder
Approvals	UL - CSA (switch)

# Pulsanti di abilitazione a 3 posizioni Ø16

## 3-position enabling switches Ø16

g

cod

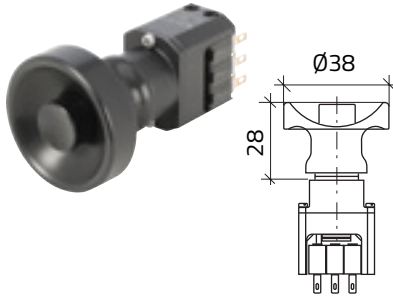

### Pulsante 3 posizioni con impugnatura ergonomica

#### 3-position push-button with ergonomic handle

Microinterruttori con terminali faston 2,8 x 0,5  
Microswitches with faston terminals 2.8 x 0.5

2NO + 2NC	70	<b>016P3PE22F</b>
3NO + 3NC	70	<b>016P3PE33F</b>

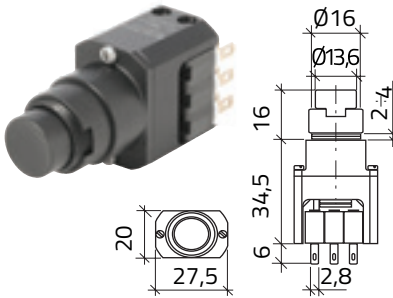

### Pulsante 3 posizioni

#### 3-position push-button

Microinterruttori con terminali faston 2,8 x 0,5  
Microswitches with faston terminals 2.8 x 0.5

2NO + 2NC	44	<b>016P3P22F</b>
3NO + 3NC	70	<b>016P3P33F</b>

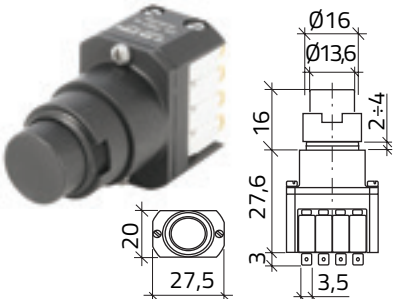

Microinterruttori con terminali T7 a saldare  
Microswitches with T7 solder terminals

2NO + 2NC	30	<b>016P3P22</b>
3NO + 3NC	31	<b>016P3P33</b>
4NO + 4NC	32	<b>016P3P44</b>

### Schema elettrico microinterruttori

#### Microswitch electrical diagram

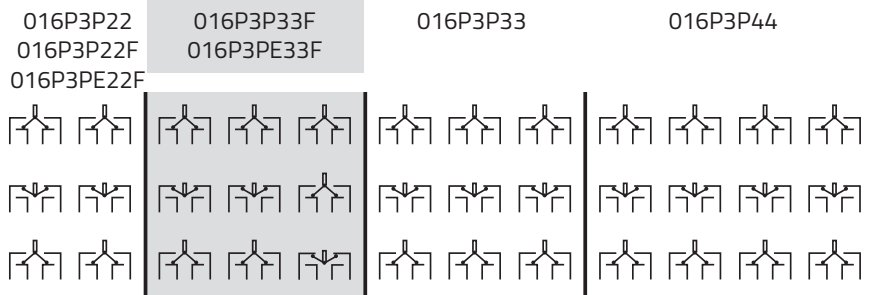
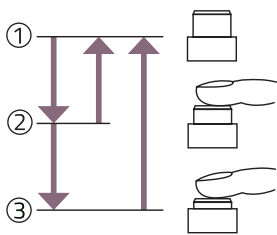

Contatto NC di controllo posizione ③  
NC contact for position control ③

# Accessori

## Accessories

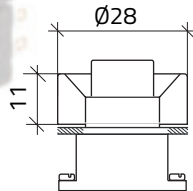

**Ghiera di riduzione  $\varnothing$  22,5 /  $\varnothing$  16**  
Reduction ring  $\varnothing$  22,5 /  $\varnothing$  16

g	n	cod
12,8		016GP28

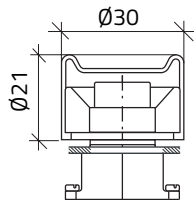

**Cappuccio in gomma / Rubber cap**

3,5	5	020CGS
-----	---	--------

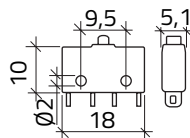
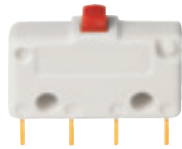

**Contatto / Contact block**

Microinterruttori con terminali T7 a saldare  
Microswitches with T7 solder terminals  
1NO + 1 NC

1,3		016E11
-----	--	--------

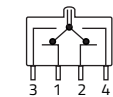

Schema del circuito  
Circuit diagram  
1+2 NC / 3+4 NO

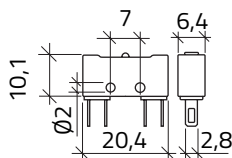
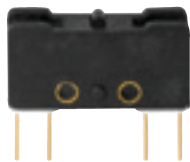

**Contatto / Contact**

Microinterruttori con terminali faston 2,8 x 0,5  
Microswitches with faston terminals 2.8x0-5  
1NO + 1 NC faston

1,3		016E11F
-----	--	---------